

NOTE: DO NOT DISCARD the Parts List from the Instruction Bulletin. Place the Parts List in the appropriate place in the machine manual for future reference. Retaining the Parts List will make it easier to reorder individual parts and will save the cost of ordering an entire kit.

NOTE: Numbers in parenthesis () are reference numbers for parts listed in Bill of Materials.

Installation instructions for **kit number 9017160**

SYNOPSIS:

This kit contains the parts needed to install the clogged filter sensor on M17 sweeper-scrubbers. Please follow step-by-step instructions.

SPECIAL TOOLS / CONSIDERATIONS: NONE

(Estimated time to complete: 30 minutes)

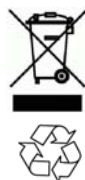

PROTECT THE ENVIRONMENT

Please dispose of packaging materials, used machine components such as batteries and fluids in an environmentally safe way according to local waste disposal regulations.

Always remember to recycle.

PREPARATION:

FOR SAFETY: Before leaving or servicing machine, stop on level surface, turn off machine, set parking brake, and remove key.

1. Disconnect the battery cable from the machine.

WARNING: Always disconnect battery cables from machine before working on electrical components.

2. Remove the hopper cover from the hopper. Set the hopper cover aside.

INSTALLATION:

1. Cut the cable tie securing the filter shaker connector and clogged filter sensor connectors to the filter box. Remove and discard the cable tie and cable tie clip. (Fig. 1)

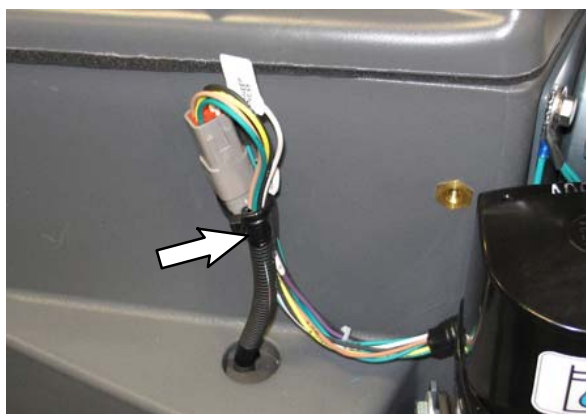

FIG. 1

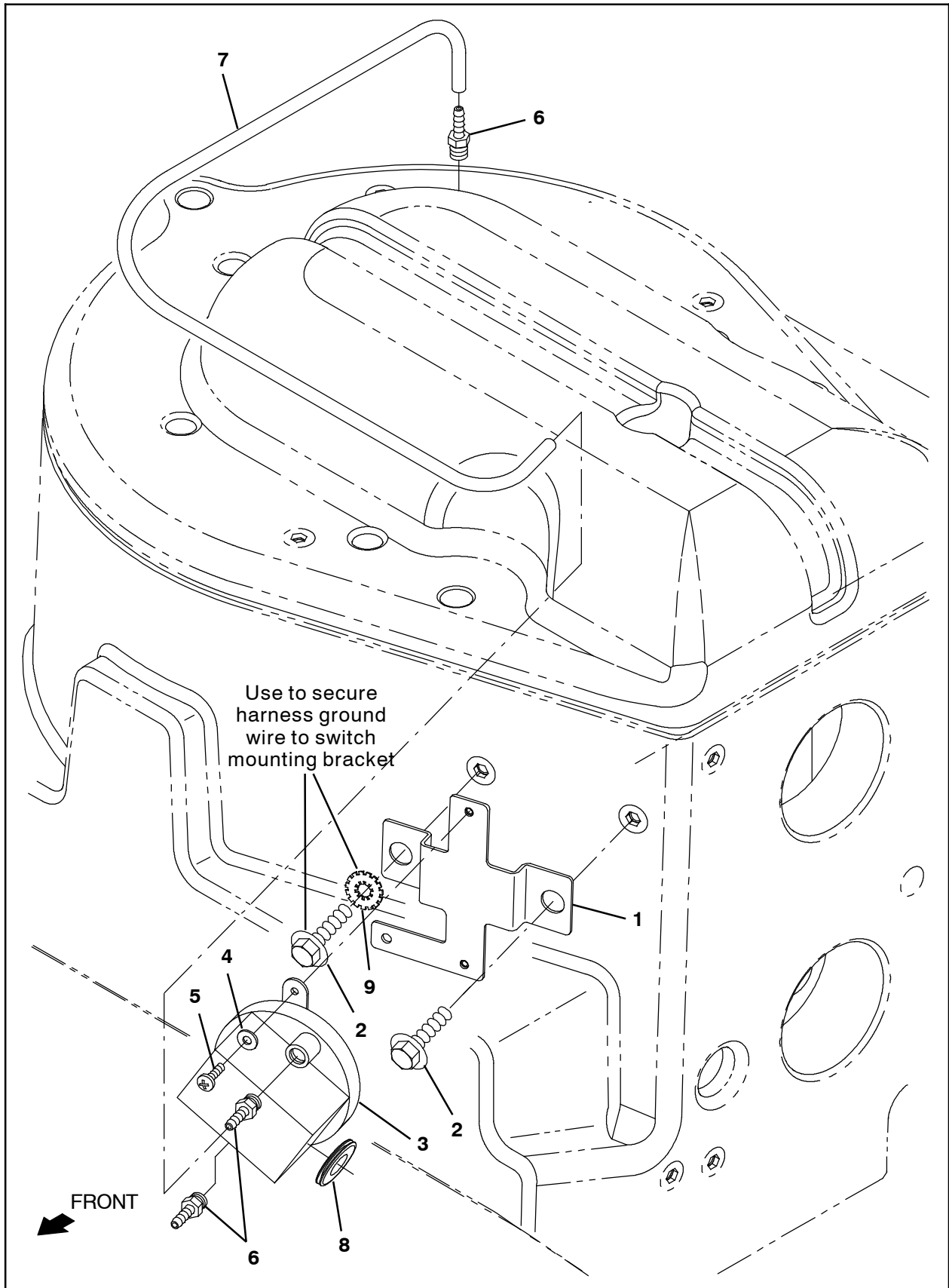

FIG. 2

- Use one M8 SEMS hex screw (2) and one lock washer (9) to install the ground wire and the switch mounting bracket (1) onto the filter box. (Fig. 2 / Fig. 3 / Fig. 9)

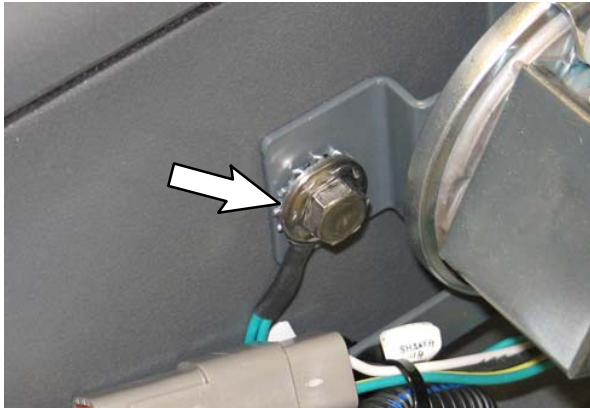

FIG. 3

- Use the remaining M8 SEMS hex screw (2) to install the switch mounting bracket (1) completely onto the filter box. (Fig. 2)
- Install a grommet (8) into the pressure switch (3). (Fig. 2)
- Use two M4 pan screws (5) and two flat washers (4) to install the pressure switch (3) onto the switch mounting bracket (1). (Fig. 2)
- Thread two brass straight fittings (6) into the pressure switch (3). (Fig. 2)
- Locate the dimple / indentation located on the top of the filter box cover and use a 11/32 in. (8.73 mm) drill bit to drill through only the top wall of the filter box cover. **Do Not** drill into the bottom wall of the filter box cover. (Fig. 4)



FIG. 4

- Thread the remaining brass straight fitting (6) into the hole drilled into the filter box cover in the previous step. (Fig. 4 / Fig. 2)

- Remove the cover from the pressure switch (3). (Fig. 5)
- Connect the hopper harness to the pressure switch (3). (Fig. 5 / Fig. 9)



FIG. 5

- Reinstall the cover onto the pressure switch (3). (Fig. 5)
- Neatly bundle all remaining loose hopper harness and use a wire tie to secure the harness to the switch mounting bracket (1). (Fig. 6)



FIG. 6

- Connect the 24 in. (610 mm) vacuum hose (7) to the pressure switch (3). (Fig. 7 / Fig. 2)



FIG. 7

14. Connect the other end of the 24 in. (610 mm) vacuum hose (7) to the brass straight fitting (6) installed in the filter box cover. (Fig. 9 / Fig. 2)



FIG. 9

15. Reconnect the battery cable to the machine.
16. Start and test the machine.

Bill Of Materials For Sensor Kit, Filter, Clogged, CI [M17] - 9017160

Ref.	Tennant Part No.	Description	Qty.
1	1216723	Bracket Wldt, Mtg, Switch	1
2	1020341	Screw, Hex, M8 X 1.25 X 20, SS, SEMS	2
3	1051800	Switch, Press	1
4	19065	Washer, Flat, 0.19B 0.44D .05, PI, 08	2
5	49697	Screw, Pan, Phl, M4 X 0.70 X 10, SS	2
6	40607	Fitting, Brs, Str, BM03/PM02	3
7	C080168	Hose, Vacuum, 0.16ID, Bulk (24 in. / 610 mm)	1
8	10632- 4	Grommet, Rbr, 0.62ID, F/0.9H, .06 Matl	1
9	41141	Washer, Lock, Int- Ext, 0.31	1

TENNANT COMPANY
P. O. Box 1452
Minneapolis, MN 55440-1452